



aptek
Instrumentation Valves,
Fittings and Accessories

PERFORMANCE UNDER PRESSURE



High Pressure Valves And Fittings



aptek
Instrumentation Valves,
Fittings and Accessories

Aptek Instrumentation Pvt. Ltd.

Unit 1, 411/5/2, 411/6, Kapasi Estate, Near Mangal Estate, GIDC Naroda, 382330.
+91-79-2284 3333, 22840081, Email : marketing@aptekenigneers.com, aptekenigneers@gmail.com

ISO 9001, 14001, 45001

www.aptekenigneers.com

Medium Pressure Valves, Fittings and Tubing

20,000 psi service

APTEK has developed a line of Medium Pressure products to assure safe and easy plumbing through 20,000 psi. These needle valves, fittings, check valves and nipples are engineered to the highest standards of repeatable quality. The reliable performance of these products has made Aptek one of the world's leading suppliers of elevated pressure components. Medium Pressure components use a compact coned-and-threaded connection which permits the larger bore sizes and increased flow rates common in this pressure class. Medium Pressure valves are available in 1/4", 3/8", 9/16", 3/4", 1" O.D. tubing sizes and six patterns to satisfy widely varied requirements. A line of fittings is available to facilitate adapting to Taper Seal, High Pressure or other threaded pipe systems.



- **Medium Pressure (coned & threaded)** type connections for 1/4", 3/8", 9/16", 3/4", 1" O.D. tubing.
- **Non-rotating slotted stems** are standard for on-off service and ensure long life on valve seats. Regulating tip stems are available for all valves.
- **Materials** include high tensile type 316 stainless steel bodies and hardened 17-4PH stainless steel lower section stems.
- **Packing** is Teflon (450°F) standard with optional Viton (350°F), BUNA-N (200°F) and Grafoil (800°F) available at no additional cost.
- **Extreme temperatures** can be accommodated by using extended stuffing boxes.

Valve Features

- Non-rotating slotted stem design
- Packing below stem threads
- Positive gland lock device
- Type 316 ss high tensile bodies

20000 psi Service Medium Pressure Valves

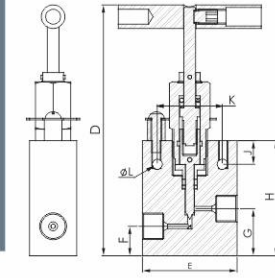

Two Way Straight Valves

Tubing	psi	Orifice	Cv	D	E	F	G	H	J	K	L	Thickness
1/4" OD	20,000	1/8"	0.17	4-3/8"	2"	3/8"	13/16"	2"	3/8"	1-1/4"	7/32"	3/4"
3/8" OD	20,000	13/64"	0.45	4-3/8"	2"	3/8"	13/16"	2"	3/8"	1-1/4"	7/32"	3/4"
9/16" OD	20,000	5/16"	1.12	6-1/8"	2-1/2"	1/2"	1-1/8"	2-7/8"	1/2"	1-3/8"	11/32"	1"
3/4" OD	20,000	7/16"	2.29	7"	3"	3/4"	1-1/2"	3-3/4"	5/8"	1-3/4"	7/16"	1-3/8"
1" OD	20,000	9/16"	3.86	8-27/64"	4-1/8"	7/8"	1-13/16"	4-5/8"	1-1/8"	2-1/2"	9/16"	1-3/4"

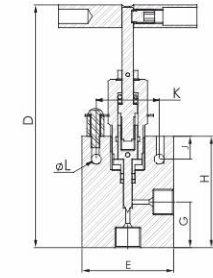

Two Way Angle Valves

Tubing	psi	Orifice	Cv	D	E	F	G	H	J	K	L	Thickness
1/4" OD	20,000	1/8"	0.255	4-13/16"	2"	-	1-1/4"	2-7/16"	3/8"	1-1/4"	7/32"	3/4"
3/8" OD	20,000	13/64"	0.675	4-13/16"	2"	-	1-1/4"	2-7/16"	3/8"	1-1/4"	7/32"	3/4"
9/16" OD	20,000	5/16"	1.68	6-5/8"	2-1/2"	-	1-5/8"	3-3/8"	1/2"	1-3/8"	11/32"	1"
3/4" OD	20,000	7/16"	3.435	7-1/2"	3"	-	2"	4-1/4"	5/8"	1-3/4"	7/16"	1-3/8"
1" OD	20,000	9/16"	5.79	9-3/8"	4-1/8"	-	2-9/16"	5-7/16"	1-1/8"	2-1/2"	9/16"	1-3/4"

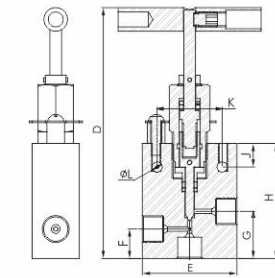

Three Way Valves / Two Pressure Connection

Tubing	psi	Orifice	D	E	F	G	H	J	K	L	Thickness
1/4" OD	20,000	1/8"	5"	2"	1"	1-7/16"	2-5/8"	3/8"	1-1/4"	7/32"	3/4"
3/8" OD	20,000	13/64"	5"	2"	1"	1-7/16"	2-5/8"	3/8"	1-1/4"	7/32"	3/4"
9/16" OD	20,000	5/16"	6-7/8"	2-1/2"	1-1/4"	1-7/8"	3-5/8"	1/2"	1-3/8"	11/32"	1"
3/4" OD	20,000	7/16"	7-7/8"	3"	2-5/8"	2-3/8"	4-5/8"	5/8"	1-3/4"	7/16"	1-3/8"
1" OD	20,000	9/16"	9-3/4"	4-1/8"	2-1/8"	3-1/16"	5-7/8"	1-1/8"	2-1/2"	9/16"	1-3/4"

20000 psi Service

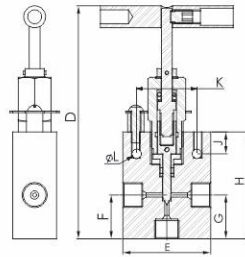

Three Way Valves / One Pressure Connect

Tubing	psi	Orifice	D	E	F	G	H	J	K	L	Thickness
1/4" OD	20,000	1/8"	4-13/16"	2"	1-1/4"	1-1/4"	2-7/16"	3/8"	1-1/4"	7/32"	3/4"
3/8" OD	20,000	13/64"	4-13/16"	2"	1-1/4"	1-1/4"	2-7/16"	3/8"	1-1/4"	7/32"	3/4"
9/16" OD	20,000	5/16"	6-5/8"	2-1/2"	1-5/8"	1-5/8"	3-3/8"	1/2"	1-3/8"	11/32"	1"
3/4" OD	20,000	7/16"	7-1/2"	3"	2"	2"	4-1/4"	5/8"	1-3/4"	7/16"	1-3/8"
1" OD	20,000	9/16"	9-3/8"	4-1/8"	2-5/8"	2-5/8"	5-7/16"	1-1/8"	2-1/2"	9/16"	1-3/4"

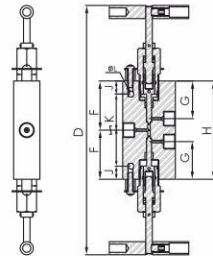

Three Way Valves / Two Stem Connection valves

Tubing	psi	Orifice	D	E	F	G	H	J	K	L	Thickness
1/4" OD	20,000	1/8"	5-3/4"	2"	1-11/16"	1-3/16"	3-3/8"	3/8"	1-1/4"	7/32"	3/4"
3/8" OD	20,000	13/64"	5-3/4"	2"	1-11/16"	1-3/16"	3-3/8"	3/8"	1-1/4"	7/32"	3/4"
9/16" OD	20,000	5/16"	8-3/8"	2-1/2"	2-9/16"	1-3/4"	5-1/8"	1/2"	1-3/8"	11/32"	1"
3/4" OD	20,000	7/16"	9-3/4"	3"	3-1/4"	2-1/4"	6-1/2"	5/8"	1-3/4"	7/16"	1-3/8"
1" OD	20,000	9/16"	12-3/16"	4-1/8"	4-1/8"	2-13/16"	8-1/4"	1-1/8"	2-1/2"	9/16"	1-3/4"

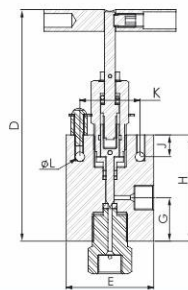

Replaceable Seat valves

Tubing	psi	Orifice	D	E	F	G	H	J	K	L	Thickness
1/4" OD	20,000	1/8"	5-5/8"	2"	-	1-1/4"	2-7/16"	3/8"	1-1/4"	7/32"	3/4"
3/8" OD	20,000	13/64"	5-5/8"	2"	-	1-1/4"	2-7/16"	3/8"	1-1/4"	7/32"	3/4"
9/16" OD	20,000	5/16"	8"	2-1/2"	-	1-5/8"	3-3/8"	1/2"	1-3/8"	11/32"	1"
3/4" OD	20,000	7/16"	8-7/8"	3"	-	2"	4-1/4"	5/8"	1-3/4"	7/16"	1-3/8"
1" OD	20,000	9/16"	11-1/6"	4-1/6"	-	2-9/16"	5-7/16"	1-1/8"	2-1/2"	9/16"	1-3/4"

20000 psi Glands/Collars/Plugs/Elbows/Tees/Crosses

A complete range of elbows, tees, and crosses is available for all of the tubing connection sizes. Material is high tensile 316 stainless steel. Standard tubing glands and collars are provided unless otherwise specified.

Connection Component

Tube Size
1/4"
3/8"
9/16"
3/4"
1"

Tube Size
1/4"
3/8"
9/16"
3/4"
1"

Tube Size
1/4"
3/8"
9/16"
3/4"
1"

Collar



Gland



Plug



Medium Pressure Elbows

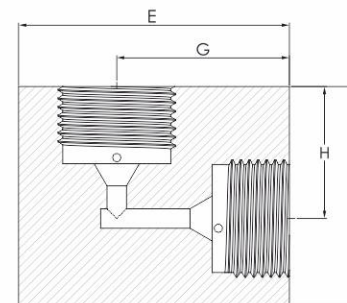

Pressure Rating psi	Connections	E	F	G	H	Thickness
20,000	1/4" O.D. TUBE	1-3/16"	1"	7/8"	11/16"	5/8"
20,000	3/8" O.D. TUBE	1-3/8"	1-3/8"	1"	1"	3/4"
20,000	9/16" O.D. TUBE	1-3/4"	1-3/4"	1-1/4"	1-1/4"	1"
20,000	3/4" O.D. TUBE	2-1/4"	2-1/4"	1-1/2"	1-1/2"	1-3/8"
20,000	1" O.D. TUBE	3"	3"	2-1/16"	2-1/16"	1-3/4"

Medium Pressure Tees

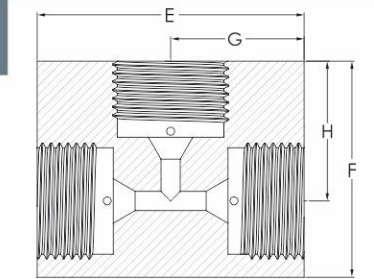

Pressure Rating psi	Connections	E	F	G	H	Thickness
20,000	1/4" O.D. TUBE	1-3/4"	1"	7/8"	11/16"	5/8"
20,000	3/8" O.D. TUBE	2"	1-3/8"	1"	1"	3/4"
20,000	9/16" O.D. TUBE	2-1/2"	1-3/4"	1-1/4"	1-1/4"	1"
20,000	3/4" O.D. TUBE	3"	2-1/4"	1-1/2"	1-1/2"	1-3/8"
20,000	1" O.D. TUBE	4-1/8"	3"	2-1/16"	2-1/16"	1-3/4"

Medium Pressure Crosses

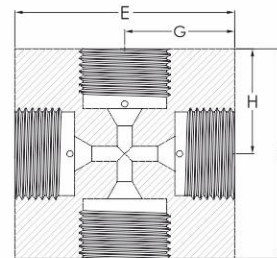

Pressure Rating psi	Connections	E	F	G	H	Thickness
20,000	1/4" O.D. TUBE	1-3/4"	1-3/8"	7/8"	11/16"	5/8"
20,000	3/8" O.D. TUBE	2"	2"	1"	1"	3/4"
20,000	9/16" O.D. TUBE	2-1/2"	2-1/2"	1-1/4"	1-1/4"	1"
20,000	3/4" O.D. TUBE	3"	3"	1-1/2"	1-1/2"	1-3/8"
20,000	1" O.D. TUBE	4-1/8"	4-1/8"	2-1/16"	2-1/16"	1-3/4"

Union Couplings (Slip Type)

Union (slip type) couplings are ideal for use in confined space installations. This design allows the entire coupling to be disconnected and slipped back over the tubing to facilitate assembly and disassembly. In installations where tubing is easily assembled, it is preferable (and less expensive) to use standard straight couplings. Standard material is high tensile 316 stainless steel. Standard tubing collars and glands are provided unless otherwise specified.

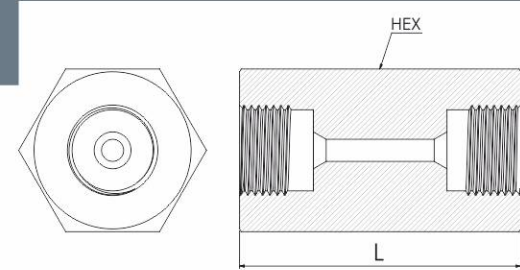

Pressure Rating psi	Connections	Orifice	Length	Hex. Size
20,000	1/4" O.D. TUBE	1/8"	1-9/16"	5/8"
20,000	3/8" O.D. TUBE	7/32"	1-3/4"	3/4"
20,000	9/16" O.D. TUBE	23/64"	2-1/8"	1"
20,000	3/4" O.D. TUBE	33/64"	2-1/2"	1-3/8"
20,000	1" O.D. TUBE	11/16"	3-1/2"	1-3/4"

Caps

Tubing end caps are offered for use in sealing off tubing ends either for temporary use or permanent use, such as on small volume reservoirs. Standard material is high tensile 316 stainless steel. Standard tubing collars and glands are provided unless otherwise specified.

Pressure Rating psi	Connections	Length	Hex. Size
20,000	1/4" O.D. TUBE	7/8"	5/8"
20,000	3/8" O.D. TUBE	1-3/8"	3/4"
20,000	9/16" O.D. TUBE	1-1/2"	1"
20,000	3/4" O.D. TUBE	2-1/2"	1-3/8"
20,000	1" O.D. TUBE	3"	1-3/4"

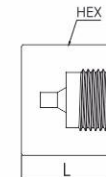

Ball Check Valves

Ball type check valves insure flow in one direction only. Material for body, caps and cover is high tensile 316 stainless steel. Standard tubing glands and collars are provided unless otherwise specified.

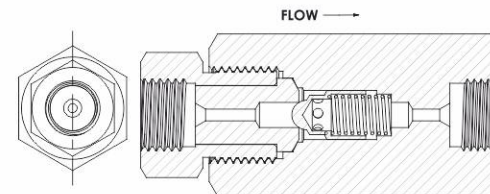

Pressure Rating psi	Orifice	Length	Thickness
20,000	1/8"	3-3/4"	1"
20,000	7/32"	3-3/4"	1"
20,000	23/64"	4-1/2"	1-3/8"
20,000	7/16"	5-1/8"	1-3/4"
20,000	9/16"	6-1/2"	2-1/2"

High Pressure Valves, Fittings and Tubing

30,000 and 40,000 psi service

APTEK has developed a line of High Pressure products to assure safe and easy plumbing for 30,000 and 40,000 psi. These needle valves, fittings, check valves and nipples are engineered to the highest standards of repeatable quality. The reliable performance of these products has made Aptek one of the world's leading suppliers of elevated pressure components. High Pressure components use a coned-and-threaded connection which accommodates the high temperatures and pressures common in these applications. High Pressure valves are available in various tubing sizes and with body designs to satisfy widely varied requirements. A line of fittings is available to facilitate adapting to Taper Seal, Medium Pressure, or other High Pressure threaded pipe systems.



Nipples

Nipples are stocked in 316 stainless steel. Nipples in lengths other than those shown in shaded are supplied upon request. Nipples are not furnished with collars and glands, unless specified at time of order.



Coned and Threaded Nipples

Length ↓	Tubing Size (O.D. X I.D.)				
	1/4" O.D. X 7/64" I.D.	3/8" O.D. X 13/64" I.D.	9/16" O.D. X 5/16" I.D.	3/4" O.D. X 7/16" I.D.	1" O.D. X 9/16" I.D.
psi →	20,000	20,000	20,000	20,000	20,000
2-3/4"					
3"					
4"					
6"					
8"					
10"					
12"					

Length ↓	Tubing Size (O.D. X I.D.)		
	1/8" X 0.040" **	1" X 0.437" **	9/16" X 1/4" *
psi →	30,000	30,000	40,000
2"			
2-3/4"			
3"			
4"			
6"			
8"			
9"			
10"			
12"			

Specify 316 SS or 304 SS when ordering.
*Also used for 30,000 psi series. **316 SS



- **High Pressure (coned & threaded)** type connections for 1/8", 1/4", 3/8", 9/16" and 1" O.D. tubing.
- **Non-rotating slotted stems** are standard on for on-off service and ensure long life on valve seats. Regulating tip stems are available for all valves.
- **Materials** include high tensile type 316 stainless steel bodies and hardened 17-4PH stainless steel lower section stems.
- **Packing** is Teflon (450°F) standard with optional Viton (350°F), BUNA-N (200°F) and Grafoil (800°F) available at no additional cost.
- **Extreme temperatures** can be accommodated using extended stuffing boxes.

Valve Features

- Non-rotating slotted stem design
- Packing below stem threads
- Type 316 ss high tensile bodies
- Positive gland lock device

30000 psi Service High Pressure Valves

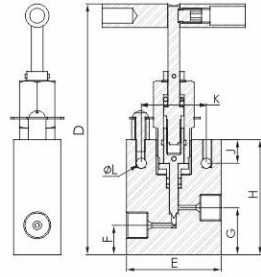

Two Way Straight Valves

Tubing	psi	Orifice	Cv	D	E	F	G	H	J	K	L	Thickness
1/8" OD	30,000	1/16"	0.04	3-1/4"	1-1/2"	11/16"	15/16"	1-13/16"	5/16"	7/8"	9/64"	3/4"
1/4" OD	30,000	3/32"	0.09	5-3/16"	2"	5/8"	1"	2-7/16"	1/2"	1-3/8"	7/32"	1"
3/8" OD	30,000	1/8"	0.15	5-3/16"	2"	5/8"	1"	2-7/16"	1/2"	1-3/8"	7/32"	1"
9/16" OD	30,000	1/8"	0.15	5-5/8"	2-5/8"	1"	1-7/16"	2-7/8"	1/2"	1-3/8"	7/32"	1-1/2"
1" OD	30,000	7/16"	2.29	8-27/64"	4-1/8"	15/16"	1-11/16"	4-7/16"	1-1/8"	2-1/2"	9/16"	1-3/4"

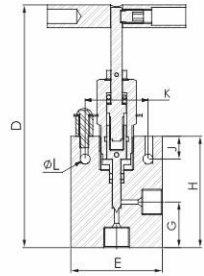

Two Way Angle Valves

Tubing	psi	Orifice	Cv	D	E	F	G	H	J	K	L	Thickness
1/8" OD	30,000	1/16"	0.06	3-1/4"	1-1/2"	-	15/16"	1-13/16"	5/16"	7/8"	9/64"	3/4"
1/4" OD	30,000	3/32"	0.135	5-3/16"	2"	-	1"	2-7/16"	1/2"	1-3/8"	7/32"	1"
3/8" OD	30,000	1/8"	0.225	5-9/16"	2"	-	1-3/8"	2-13/16"	1/2"	1-3/8"	7/32"	1"
9/16" OD	30,000	1/8"	0.225	5-5/8"	2-5/8"	-	1-7/16"	2-7/8"	1/2"	1-3/8"	7/32"	1-1/2"
1" OD	30,000	7/16"	3.435	9-11/32"	4-1/8"	-	2-3/8"	5-1/8"	1-1/8"	2-1/2"	9/16"	1-3/4"

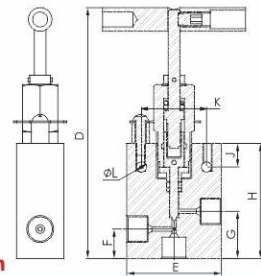

Three Way Valves / Two Pressure Connection

Tubing	psi	Orifice	D	E	F	G	H	J	K	L	Thickness
1/8" OD	30,000	1/16"	3-1/4"	1-1/2"	11/16"	15/16"	1-13/16"	5/16"	7/8"	9/64"	3/4"
1/4" OD	30,000	3/32"	5-3/16"	2"	5/8"	1"	2-7/16"	1/2"	1-3/8"	7/32"	1"
3/8" OD	30,000	1/8"	5-9/16"	2"	1"	1-3/8"	2-13/16"	1/2"	1-3/8"	7/32"	1"
9/16" OD	30,000	1/8"	6-1/16"	2-5/8"	1-7/16"	1-7/8"	3-5/16"	1/2"	1-3/8"	7/32"	1-1/2"
1" OD	30,000	7/16"	9-23/32"	4-1/8"	2-3/8"	2-13/16"	5-9/16"	1-1/8"	2-1/2"	9/16"	1-3/4"

30000 psi Service

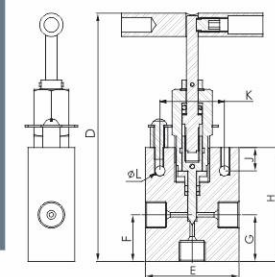

Three Way Valves / One Pressure Connection

Tubing	psi	Orifice	D	E	F	G	H	J	K	L	Thickness
1/8" OD	30,000	1/16"	3-1/4"	1-1/2"	15/16"	15/16"	1-13/16"	5/16"	7/8"	9/64"	3/4"
1/4" OD	30,000	3/32"	5-3/16"	2"	1"	1"	2-7/16"	1/2"	1-3/8"	7/32"	1"
3/8" OD	30,000	1/8"	5-9/16"	2"	2"	1-7/16"	2-13/16"	1/2"	1-3/8"	7/32"	1"
9/16" OD	30,000	1/8"	5-5/8"	2-5/8"	2-3/16"	1-7/16"	2-7/8"	1/2"	1-3/8"	7/32"	1-1/2"
1" OD	30,000	7/16"	9-11/32"	4-1/8"	2-3/8"	2-3/8"	5-1/8"	1-1/8"	2-1/2"	9/16"	1-3/4"

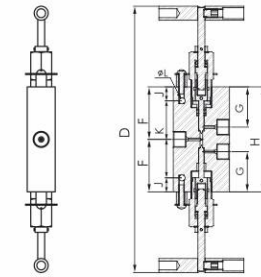

Three Way Valves / Two Stem Connection valves

Tubing	psi	Orifice	D	E	F	G	H	J	K	L	Thickness
1/8" OD	30,000	1/16"	5-1/4"	1-1/2"	15/16"	7/8"	2-1/2"	5/16"	1-7/8"	9/64"	3/4"
1/4" OD	30,000	3/32"	9-1/4"	2"	1"	1-7/16"	3-3/4"	1/2"	2-3/4"	7/32"	1"
3/8" OD	30,000	1/8"	9-1/2"	2"	2"	1-7/16"	4"	1/2"	3"	7/32"	1"
9/16" OD	30,000	1/8"	9-7/8"	2-5/8"	2-3/16"	1-7/16"	4-3/8"	1/2"	3-3/8"	7/32"	1-1/2"
1" OD	30,000	7/16"	11-13/16"	4-1/8"	3-7/8"	2-3/4"	7-3/4"	1-1/8"	2-1/2"	9/16"	1-3/4"

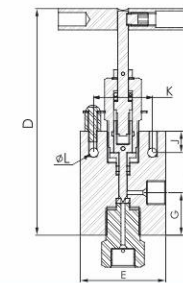

Replaceable Seat valves

Tubing	psi	Orifice	D	E	F	G	H	J	K	L	Thickness
1/4" OD	30,000	3/32"	6"	2"	-	1"	2-7/16"	1/2"	1-3/8"	7/32"	1"
3/8" OD	30,000	1/8"	6-5/8"	2"	-	1-3/8"	2-13/16"	1/2"	1-3/8"	7/32"	1"
9/16" OD	30,000	1/8"	6-13/16"	2-5/8"	-	1-7/16"	2-7/8"	1/2"	1-3/8"	7/32"	1-1/2"
1" OD	30,000	7/16"	10-7/8"	4-1/8"	-	2-3/8"	5-1/8"	1-1/8"	2-1/2"	9/16"	1-3/4"

30000 psi Glands/Collars/Plugs/Elbows/Tees/Crosses

A complete range of elbows, tees, and crosses is available for all of the tubing connection sizes. Material is high tensile 316 stainless steel. Standard tubing glands and collars are provided unless otherwise specified.

Connection Component

Tube Size
1/8"
1/4"
3/8"
9/16"
1"

Collar



Tube Size
1/8"
1/4"
3/8"
9/16"
1"

Gland



Tube Size
1/8"
1/4"
3/8"
9/16"
1"

Plug



High Pressure Elbows

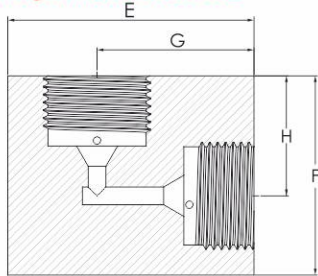

Pressure Rating psi	Connections	E	F	G	H	Thickness
30,000	1" O.D. TUBE	3"	3"	2-1/16"	2-1/16"	1-3/4"
40,000	9/16" O.D. TUBE	2-5/8"	1-7/8"	1-7/8"	1-1/8"	1-1/2"

High Pressure Tees

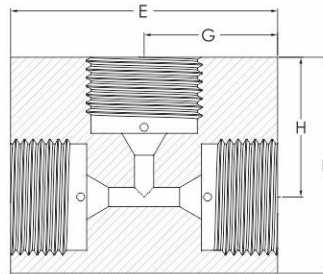

Pressure Rating psi	Connections	E	F	G	H	Thickness
30,000	1" O.D. TUBE	4-1/8"	3"	2-1/16"	2-1/16"	1-3/4"
40,000	9/16" O.D. TUBE	c 2-5/8"	2-1/8"	1-5/16"	1-3/8"	1-1/2"

High Pressure Crosses

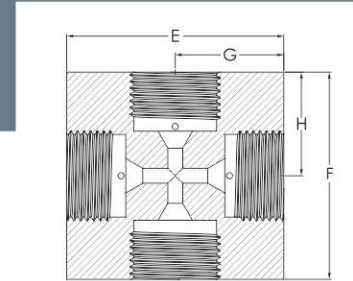

Pressure Rating psi	Connections	E	F	G	H	Thickness
30,000	1" O.D. TUBE	4-1/8"	4-1/8"	2-1/16"	2-1/16"	1-3/4"
40,000	9/16" O.D. TUBE	2-3/4"	2-5/8"	1-3/8"	1-5/16"	1-1/2"

Union Couplings (Slip Type)

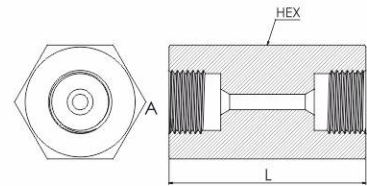

Union (slip type) couplings are ideal for use in confined space installations. This design allows the entire coupling to be disconnected and slipped back over the tubing to facilitate assembly and disassembly. In installations where tubing is easily assembled, it is preferable (and less expensive) to use standard straight couplings (see accessories section). Standard material is high tensile 316 stainless steel. Standard tubing collars and glands are provided unless otherwise specified.

Pressure Rating psi	Connections	B	Length	Hex. Size
30,000	1" O.D. TUBE	HF16	3-1/2"	1-3/4"
40,000	9/16" O.D. TUBE	HF9	2-3/8"	1-3/8"

Caps

Tubing end caps are offered for use in sealing off tubing ends either for temporary use or permanent use such as on small volume reservoirs. Standard material is high tensile 316 stainless steel. Standard tubing collars and glands are provided unless otherwise specified.

Pressure Rating psi	Connections	Length	Hex. Size
30,000	1" O.D. TUBE	3-1/2"	1-3/4"

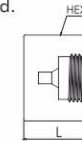

Ball Check Valves

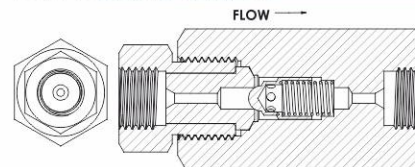

Ball type check valves insure flow in one direction only. Material for bodies and covers is 316 stainless steel. Standard tubing glands and collars are provided unless otherwise specified.

Pressure Rating psi	Connections	Length	Thickness
30,000	1" HIGH PRESSURE	6-1/2"	2-1/2" RD with flats
40,000	9/16" HIGH PRESSURE	5-1/8"	1-1/2"

40000 psi High Pressure Valves

- High Pressure (coned & threaded) type connections for 9/16" O.D. tubing.
- Non-rotating slotted stems are standard for on-off service and ensure long life on valve seats. Regulating tip stems are available for all valves.
- Materials include high tensile type 316 stainless steel bodies and hardened 17-4PH stainless steel lower section stems.
- Packing set consists of multiple Teflon packing with nylon back up, with optional Viton (350°F), BUNA-N (200°F) and Grafoil (800°F) available at no additional cost.



Valve Features

- Non-rotating slotted stem design
- Packing below stem threads
- Type 316 ss high tensile bodies
- Positive gland lock device

40000 psi Service

Two Way Straight Valves

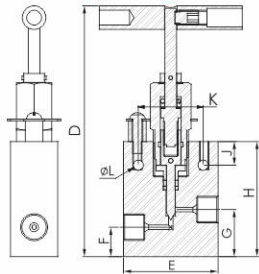

Tubing	psi	Orifice	Cv	D	E	F	G	H	J	K	L	Thickness
9/16" OD	40,000	1/8"	0.15	5-5/8"	2-5/8"	1"	1-7/16"	2-7/8"	1/2"	1-5/8"	7/32"	1-1/2"

Two Way Angle Valves

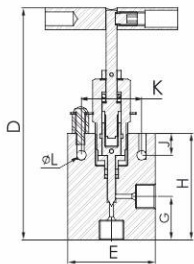

Tubing	psi	Conn.	Orifice	Cv	D	E	F	G	H	J	K	L	Thickness
9/16" OD	40,000	HF9	1/8"	0.225	5-5/8"	2-5/8"	-	1-7/16"	2-7/8"	1/2"	1-5/8"	7/32"	1-1/2"

Three Way Valves / Two Pressure Connection

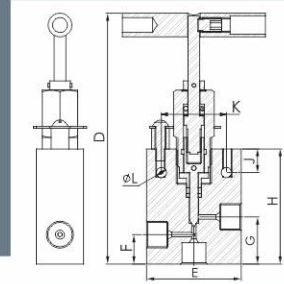

Tubing	psi	Orifice	D	E	F	G	H	J	K	L	Thickness
9/16" OD	40,000	1/8"	6-1/16"	2-5/8"	1-7/16"	1-7/8"	3-5/16"	1/2"	1-5/8"	7/32"	1-1/2"

Three Way Valves / One Pressure Connection

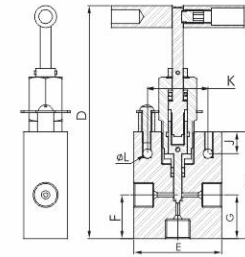

Tubing	psi	Orifice	D	E	F	G	H	J	K	L	Thickness
9/16" OD	40,000	1/8"	5-5/8"	2-5/8"	1-7/16"	1-7/16"	2-7/8"	1/2"	1-5/8"	7/32"	1-1/2"

Three Way Valves / Two Stem Connection valves

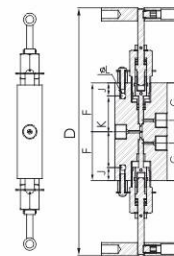

Tubing	psi	Orifice	D	E	F	G	H	J	K	L	Thickness
9/16" OD	40,000	1/8"	9-7/8"	2-5/8"	2-3/16"	1-7/16"	4-3/8"	1/2"	3-3/8"	7/32"	1-1/2"

Replaceable Seat valves

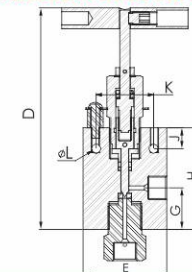

Tubing	psi	Orifice	D	E	F	G	H	J	K	L	Thickness
9/16" OD	40,000	1/8"	6-3/8"	2-5/8"	-	1-7/16"	2-7/8"	1/2"	1-5/8"	7/32"	1-1/2"